

- NOTES:
1. DO NOT SCALE. USE FIGURED DIMENSIONS ONLY.
 2. THIS DRAWING IS TO BE READ IN CONJUNCTION WITH ALL OTHER RELEVANT ARCHITECTURAL AND ENGINEERING DRAWINGS.

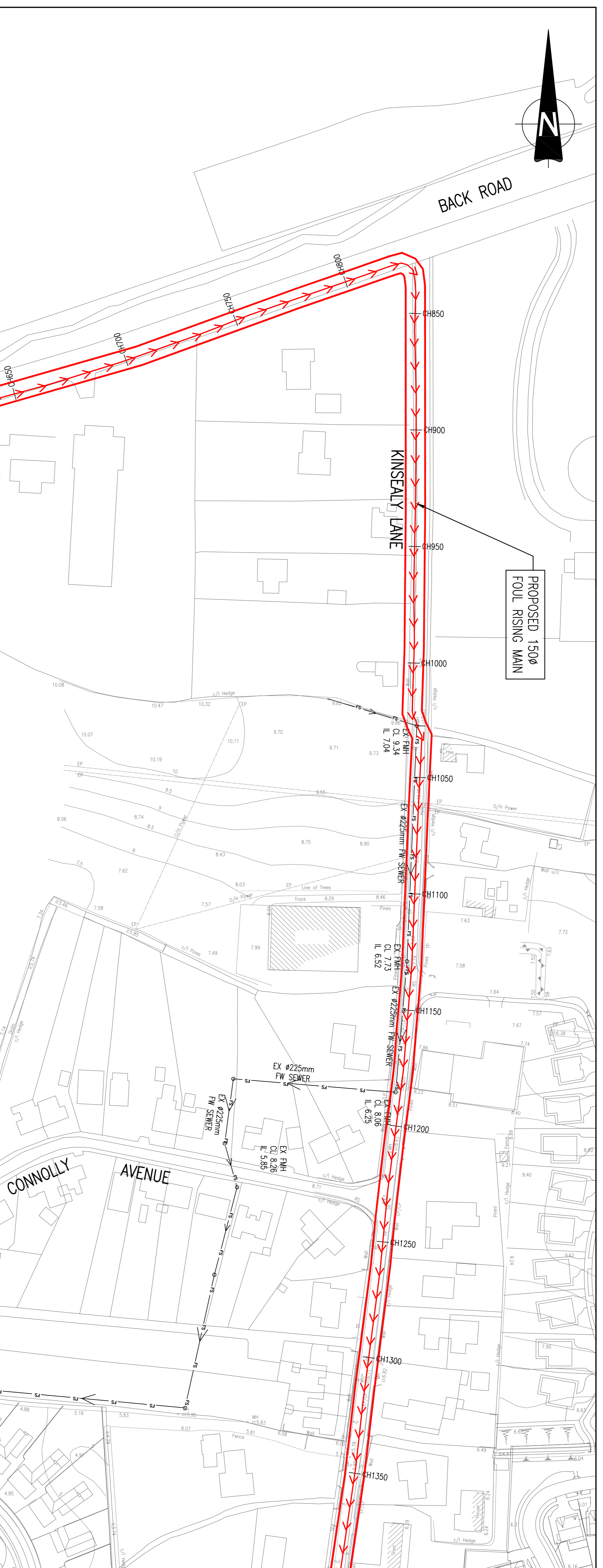

FOWL RISING MAIN PLAN SHEET 2 OF 4
SCALE 1:1000

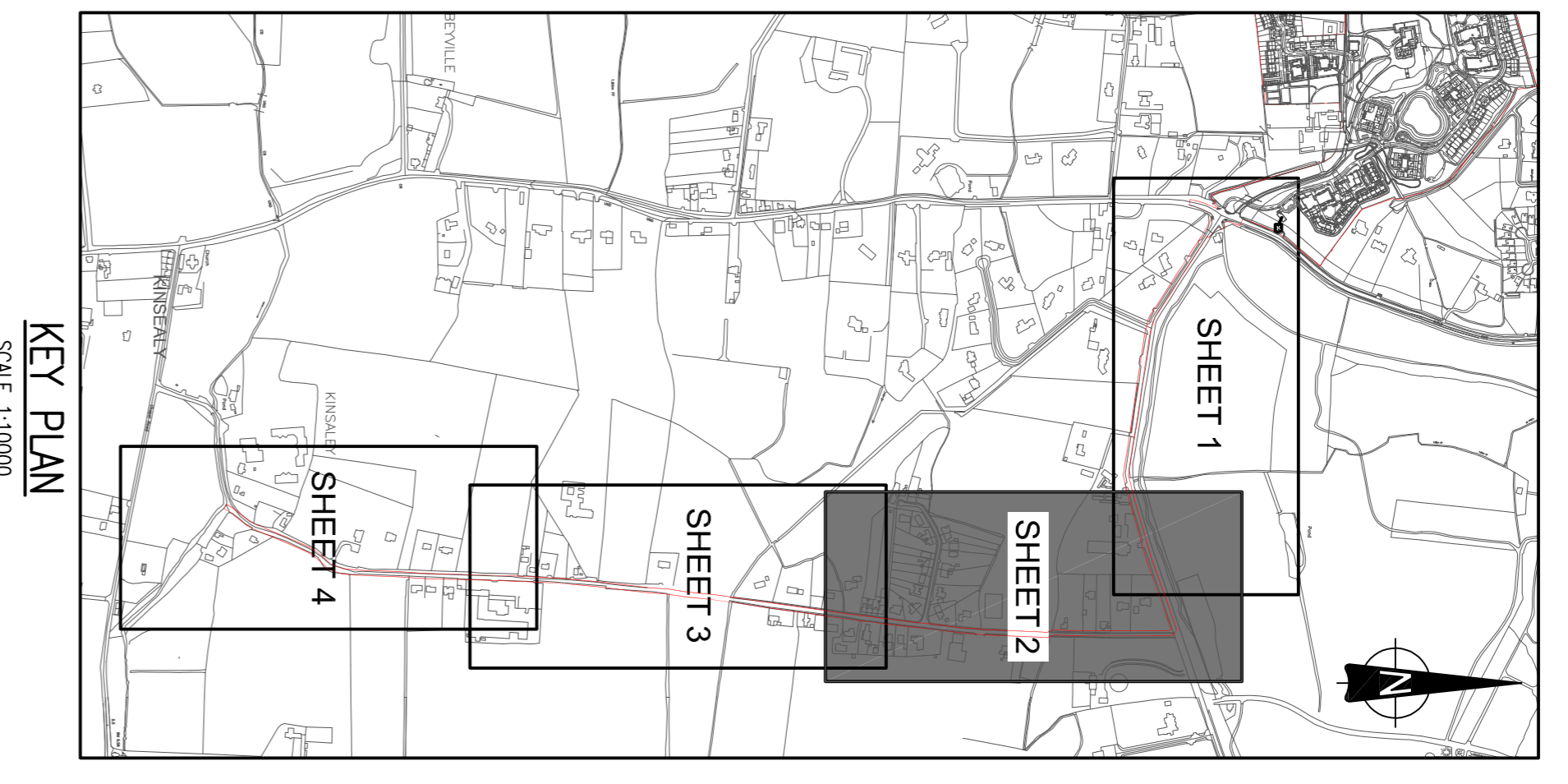

KEY PLAN
SCALE 1:10000

LEGEND:

- PROPOSED FOWL WATER SEWER
- EXISTING FOWL SEWER
- PROPOSED 1500 FOWL RISING MAIN

CHAINAGE	WATERMAIN INVERT	GROUND LEVEL	DIAMETER (mm)	DATA RM 1.000
650.000	8.980	9.980	100	
700.000	8.980	10.635	100	
750.000	9.635	10.635	100	
800.000	10.290	11.295	100	
850.000	10.390	11.395	100	
900.000	9.470	10.475	100	
950.000	8.635	9.635	100	
1000.000	8.665	9.665	100	
1050.000	8.665	9.670	100	
1100.000	7.600	8.605	100	
1150.000	6.800	7.800	100	
1200.000	7.240	8.240	100	
1250.000	7.625	8.635	100	
1300.000	6.295	7.305	100	

FOWL RISING MAIN LONG SECTION FROM CH650 TO CH 1300
SCALE 1:1000

Mar 31, 2021 - 10:11am

Drawing Location: M:\Projects\19\19-020 - Malahide Road\Drawings\Watermain\Kinsealy\Planning\A\used Drawings\19-020-0208 TO P2011 Fowl Rising Main Outfall Long Section.dwg

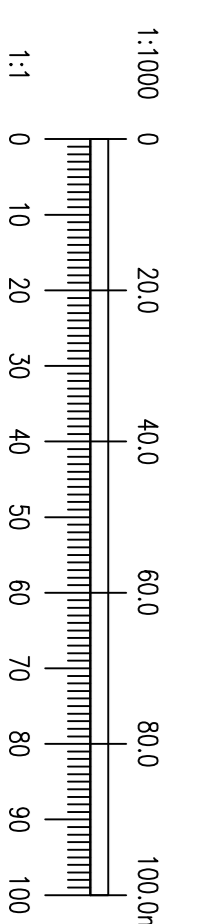

<p>Ordnance Survey Ireland Licence No. EN 0006021 © Ordnance Survey Ireland/Government of Ireland.</p>			
REV. DATE	AMENDMENT	PJD	MD
A	01/07/21 REVISED FOR FINAL SUBMISSION		
STATUS		PLANNING	
<p>Waterman Moylan Engineering Consultants BLOCK 5, EASTPOINT BUSINESS PARK, ALFIE BRYNE ROAD, DUBLIN D08 H9F4 IRELAND. TEL: (01) 964 8900 Email: info@watermanmoylan.ie www.watermanmoylan.ie</p>			
CLIENT		KINWEST LTD.	
ARCHITECT		CONROY CROWE KELLY ARCHITECTS	
PROJECT		ALBURN, MALAHIDE, CO. DUBLIN	
DRAWN	DESIGNED	APPROVED	DATE
PJD	MD	MD	SEPT '20
SCALE	JOB NO.	REV. NO.	REVISION
1:1000 @ A1	19-020	P209	A
<p>FOWL RISING MAIN PLAN AND LONG SECTION SHEET 2 OF 4</p>			